

Outdoor Radiation Temperature Sensor

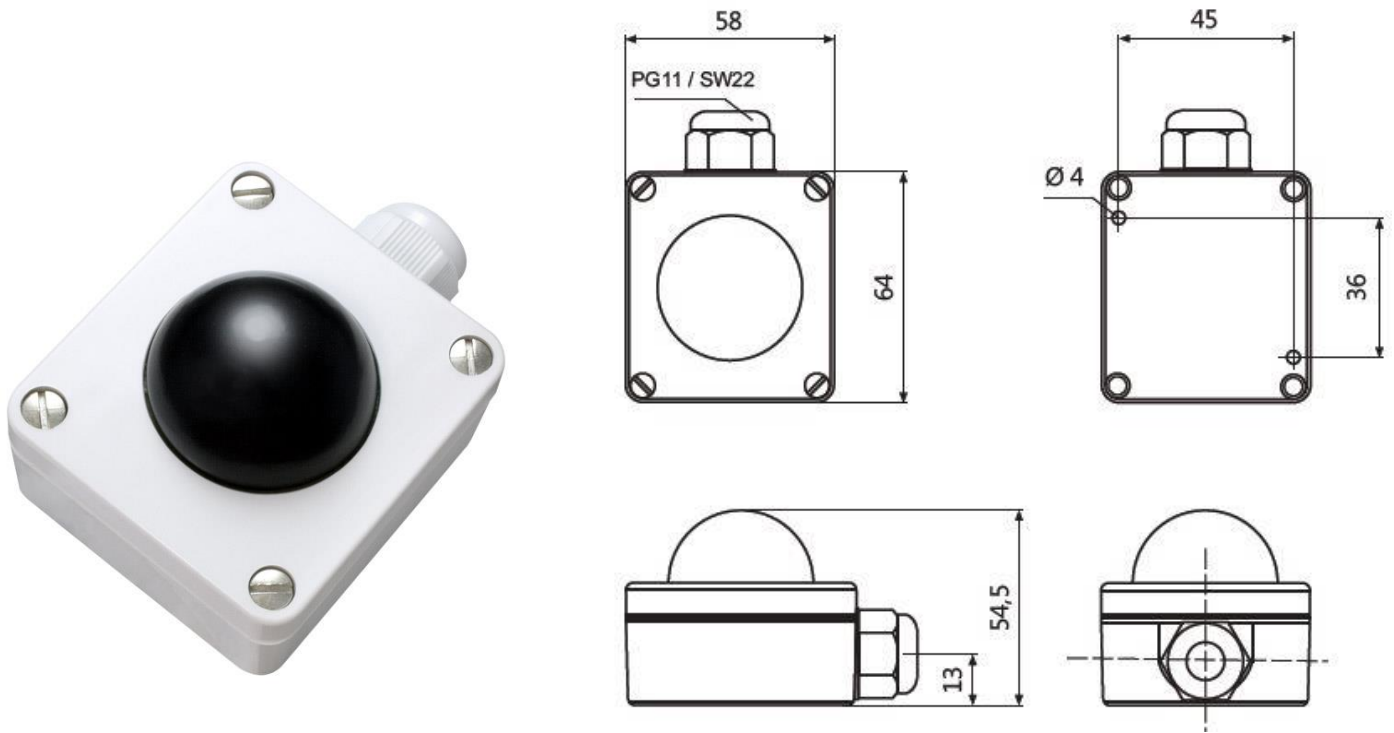

A radiation sensor measures the thermal radiation in the range of -30 up to +75°C and is with all current sensors available. The temperature probe can be mounted in climate-sensitive areas e.g. on outside walls, whereby the humidity-proof plastic housing protects the sensor optimally from outside influences.

- Measurement range temp: -30...+75°C
- Sensor: Pt100
- Circuit type: 2-wire connection
- Measurement current: approx. 1 mA
- Electrical connection: screw terminals max. 1,5 mm²
- Leakage resistance: > 100 MOhm, at +20°C (500 V DC)
- Housing: polyamide with snap closing screws, colour white like RAL 9010
- Cable gland: PG11 high-strength cable gland with strain relief
- Material: Globe: aluminium (black)
- Dimensions: Globe: Ø 40 mm
- Protection type: IP65
- Storage temperature: -20...+70°C
- Installation: screw fastening
- Standards: CE-conformity, GOST, RoHS